



Molded Natural (Virgin PP) Cartridge Filter Housings - Standard Design

GPS Standard Virgin Polypropylene Filter Housings are made of virgin polypropylene with innovative features like lower pressure drop at higher flow rate, larger connections, air venting provision, robust knife-edge, molded structure, zero bypass and leak proof sealing. These housings are ideal for maintaining high standards of purity in critical contamination control systems and processes. They are precision molded with highly polished contact surfaces to reduce the chances of bacterial adhesion, and contain no fillers, colorants, plasticizers or lubricants.

These Filter Housings offer excellent chemical resistance characteristics. Smaller size and overall dimensions make them ideal for mounting in series. They are sealed with top seated Buna-N/Silicon/Viton* 'O' ring by positive tangential contact that eliminates accidental misplacement.

Caps are manufactured of virgin polypropylene and are available with 1/2" and 3/4" BSP connections to match various flow rating and piping configurations.

All caps come with four mounting brackets for easy installation.

All housings have been tested and passed the hydrostatic leak and burst pressure to ensure consistence safe performance.

*Viton is a registered **trademark** of Dupont.

Fetures & Benefits:

- Virgin Polypropylene offering Longer Life
- Lower Pressure Drop @ Higher Flow Rate
- Molded Construction for Product Consistency
- Robust knife-edge design ensures consistent cartridge sealing
- Thicker Walls for Increased Strength
- Leak Proof Sealing
- Wide Chemical Compatibility
- Larger Connection for Maximum Output
- Mounting Holes Provision

Molded Natural (Virgin PP) Cartridge Filter Housings - Standard Design

Compatible with most membrane cartridges, they are ideal for use with deionized and reagent grade water and chemicals, pharmaceuticals grade solvents, electronic etching solutions and more.

Molded Natural (Virgin PP) Cartridge Filter Housings - Standard Design

Materials of construction

Sump: Virgin Polypropylene
Head: Virgin Polypropylene
Seal: Silicon

Configurations

Inlet/Outlet connection: 1/2", 3/4"
Connection type: Threaded BSP (F)
Cartridge type: DOE
Vent: Not Provided

Operating conditions

Max. Operating Pressure: 10 kg/cm²
Max. Operating Temperature: 90⁰C

Cartridge Capacity

Single

Cartridge dimensions accepted

63 mm OD X 10"/254 mm

Cartridge configurations accepted

Double Open End type

Design Options

Molded construction

Molded Natural (Virgin PP) Cartridge Filter Housings - Standard Design

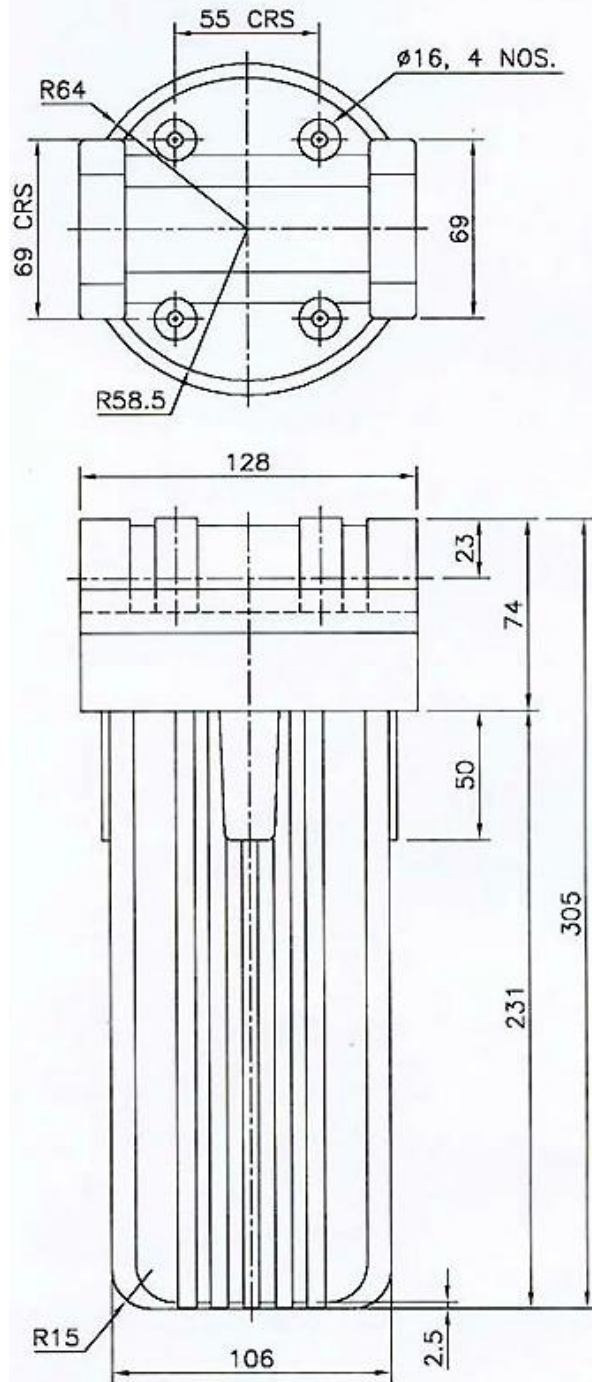

GOPANI PRODUCT SYSTEMS

MODEL NO. : ,		WEIGHT :	QTY. : 1 NO.
DWG. NO. : ,	REF. NO. : ,	MAT./SIZE : ,	
DRAWN :	.		
CHD. :			
APP. :			
REV. :	DATE : 21/01/2004	SCALE : 1 : 2.5	

Molded Natural (Virgin PP) Cartridge Filter Housings - Standard Design Request a Quote or More Information

*Name :

Company :

Title/Department :

*Phone :

*Email :

Address :

Country :

Comments :

Please have someone contact me.

Please send me a quote.

- I am interested in (please check one or more):
- Filter Housings for Liquid Filtration
 - Filter Housings for Air/Gas Filtration
 - Filter Media for Liquid Filtration
 - Filter Media for Air/Gas Filtration
 - Sintered Filter Media
 - Hydraulic Filters
 - Domestic Water Purifiers
 - Whole House Filtration Systems

How did you hear about us?